

precision one-way flow control valve GRP-160-1/8-AL

Part number: 542023

FESTO

Serves for precise adjustment of the flow rate, with non-return function.

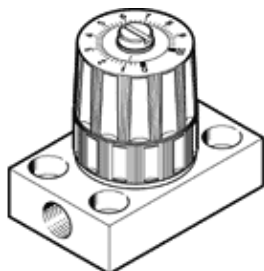

Data sheet

Feature	Value
Valve function	One-way flow control function
Pneumatic connection, port 1	G1/8
Pneumatic connection, port 2	G1/8
Type of actuation	manual
Adjusting element	Rotary knob with scale
Mounting type	On sub-base
Standard nominal flow rate in flow control direction	75.8 l/min
Standard nominal flow rate in non-return direction	245 l/min
Operating pressure	0 ... 8 bar
Ambient temperature	-10 ... 50 °C
Material housing	PA-reinforced
Assembly position	Any
Operating pressure from 2 to 1	0 ... 8 bar
Standard nominal flow rate in flow control direction from 1 bar to 0 bar	38 l/min
Standard nominal flow rate in non-return direction from 1 bar to 0 bar	25 ... 90 l/min
Standard flow rate in direction of flow control: 6 → 0 bar	129 l/min
Standard flow rate in blocked direction: 6 → 0 bar	245 l/min
Operating medium	Compressed air to ISO8573-1:2010 [5:4:3] Inert gases
Note on operating and pilot medium	Lubricated operation not possible
Medium temperature	-10 ... 50 °C
Product weight	110 g
Materials note	Contains PWIS substances Conforms to RoHS
Material of connecting plate	Wrought Aluminium alloy
Material seals	NBR PVC
Material screws	Steel